



Power.Gate

The universal multi-talent among parking columns offers comprehensive possibilities for the ticketing sector with the most modern and diverse ticket technology. Expand your business models; become part of urban solutions. Power.Gate will support you at its best!

Your Business Card

- **High-quality design**
High-class materials and salient features blend elegantly into all types of architecture.
- **Professional Image**
Bi-directional video communication guarantees optimal customer support.
- **Leave a Lasting Impression**
The user interface has been optimized by experts in terms of its look and sound to ensure positive user experiences.

Marketing Terminal with Ticketing

- **Unrestricted Marketing Possibilities**
Finance your own equipment.
- **Professional Image**
A backlit, bright, and high-resolution display draws attention to logos, images and promo videos most effectively.

Optimize Your Investment

- **Fitting for Every Budget**
A customized solution for every application.
- **Protect Your Investment**
Long-term prospects and upgradeability through flexible installation and extension options.
- **Individual Profitability and Growth**
Stepwise investment in expansion and replacements is made possible thanks to SKIDATA's mix-and-match parking columns.

Increasing Efficiency through Quality

- **Optimized Service Planning**
Scalable capacities and intelligent systems reduce your service costs.
- **Advanced Technology**
Contactless RFID and barcode technology guarantee the highest level of reliability and low follow-up costs.

Save Money and Protect the Environment

- **Minimize Your Power Usage**
Context-dependent power saving modes and no heating at temperatures above -20°C (-4°F) provide a high level of energy efficiency.
- **Recyclable Materials**
Conserve valuable resources through a significant use of renewable sources.

all dimensions in mm

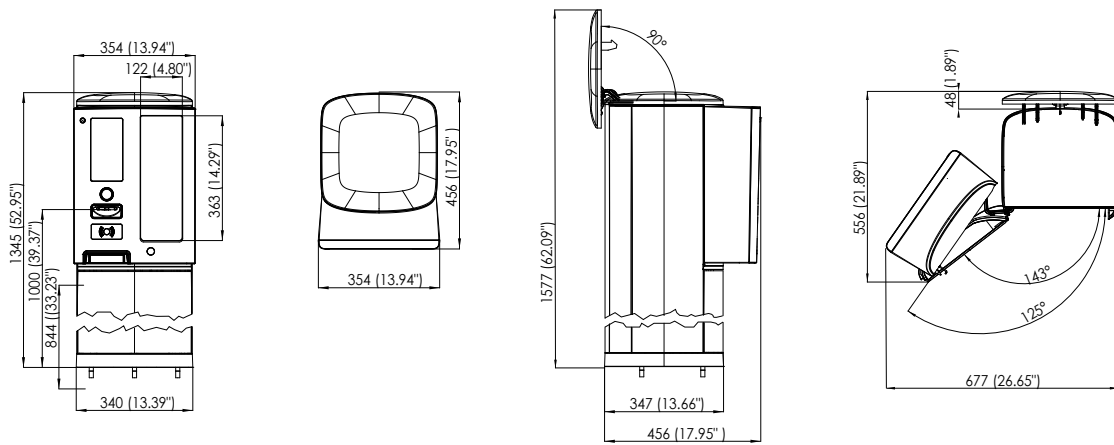

Features

Design/Construction

- Unique design based on aluminum and high-grade synthetics, complemented by optional, stylish light elements
- Modular, easy to maintain construction
- Flexible extension options ensure maximum investment protection
- Weather-proof, thanks to the use of high-grade durable materials, such as aluminum
- Ethernet interface for efficient system integration
- Large installation space for add-on modules (e.g., PIN pad, credit card reader, etc.)

Operation

- Intuitive user interaction helps to ensure very high processing rates

Green Efficiency

- Optimised for low power consumption; without Coder no heating is required down to -20 °C (-4 °F)
- Materials provide a high degree of reusability

Options

Design/Construction

- LED light bar serves as a stylish, illuminated eye-catcher
- Housing available in custom colors

Ticket Processing

- Coder Unlimited ensures flexible ticket processing
- Coder Basic enables crosswise barcode ticket processing and punch-hole validation
- RFID module to read and encode RFID tickets (13 MHz)
- Double ticket intake (up to 2x7000 tickets, depending on ticket material and coder type) with automatic data carrier management
- Intake which is compatible with RFID tickets (Option)

- Large ticket collecting box (holds approx. 3000 tickets)
- Print@Home scanner with special optical array for paper tickets and Smartphones; supports various formats
- Receipt printer accommodates for the entire credit card solution
- Barcode ticket slot for 'classic' ticketing

Communication

- Analog intercom
- Integrated digital intercom (Ethernet or 2-Wire)
- Bidirectional (i. e., duplex) video communication (solution includes camera hardware)

Display

- Bright high-resolution graphics display ensures good readability under any light conditions; supports clear, vivid display of commercials and videos (with automatic brightness adjustment); 800 × 480 pixels
- A touch screen that is suitable for outdoor use to provide additional parking column functionality (can be operated while wearing protective gloves)
- Sophisticated display modes support various applications and design options
- Illuminated control elements
- Visual and acoustic feedback provides additional user support

Accessories

- Locking system with mechanical or electronic locks, supports configurable access permissions
- Various contact and interface extensions to suit a wide range of requirements
- Heating and cooling for extreme ambient temperatures
- Info field at the front
- AFILS Acoustic support for clear intelligibility
- Advertising panel
- Lane signal
- Base for truck lanes 40, 60, 80, 100, 120 cm

Technical Details

Dimensions	354 mm × 1345 mm × 456 mm / 13.94" × 52.95" × 17.95" (w × h × d) without any additional options
Weight	approx. 30 kg
Operating voltage	100-240 V ±10 % / 50-60 Hz
Power consumption	Min. 18 W Max. 270 W (fully equipped with heating)
Coding units	Coder Unlimited or Coder Basic
Operating temperature with Coder	0 °C (32 °F) to + 50 °C (122 °F) in shade; + 40 °C (104 °F) when exposed to sunlight
Operating temperature without Coder	-20 °C (-4 °F) to + 50 °C (122 °F) in shade; + 40 °C (104 °F) when exposed to sunlight
Operating temperature with additional cooling	up to + 50 °C (122 °F) when exposed to sunlight
Operating temperature with an additional heater	down to -30 °C (-22 °F)
Operating temperature with an additional large heater	down to -40 °C (-40 °F)
Max. humidity	90 % (non-condensing)
Standard colors	Base: Brushed, anodized aluminum; Cover: Dusty gray RAL 7037, synthetic; Panel: Dark gray RAL 7021, synthetic
Declarations / Certifications	CE, FCC, IC, _c NRTL _{us}
Degree of protection based on IEC 60529	IP43
System requirements	Parking.Logic V07 or higher

SKIDATA, Inc. • One Harvard Way, Suite 5, Hillsborough • NJ 08844

[t] (908) 243-0000 • [f] (908) 243-0660 • [e] info.usa@skidata.com [w] www.skidatausa.com • Version 1.8 • 05.07.2017

©2017 SKIDATA AG. All rights reserved.

The content provided herein is subject to change and possible editorial errors. Country-specific versions may vary. SKIDATA® is a registered trademark of SKIDATA AG in the USA, the European Union and other countries. Terms and conditions of the authorized SKIDATA distributor apply. The operator is fully responsible for compliance with any legal provisions applicable to the operation of the products.